

Special Session on Excellence science contributing to more resilient critical assets

# Resilience through Structural Robustness

José M. Adam  
joadmar@upv.es

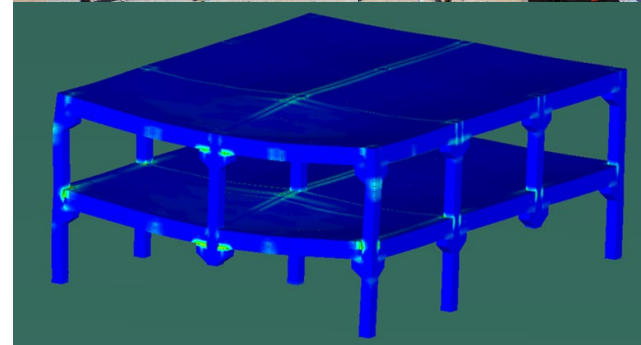
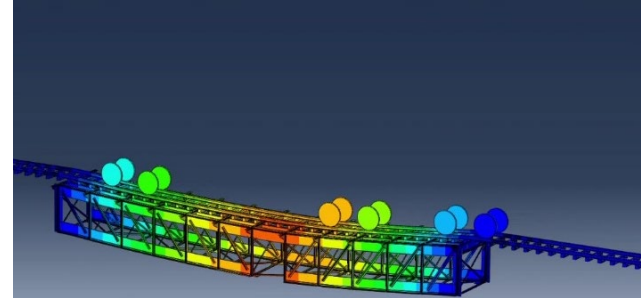

## Research at Building Resilient – 2 ongoing projects

### Steel truss bridges

#### Assessment + robustness

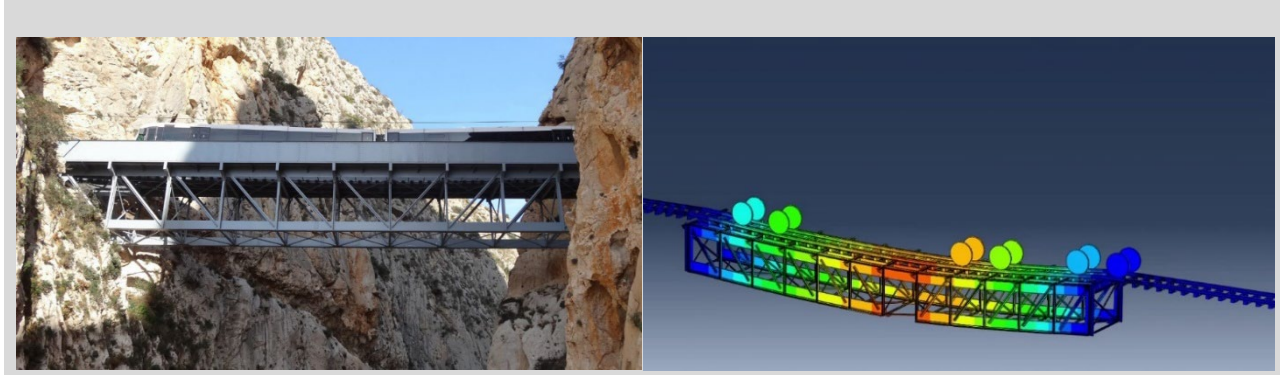

### Building structures

#### Robustness

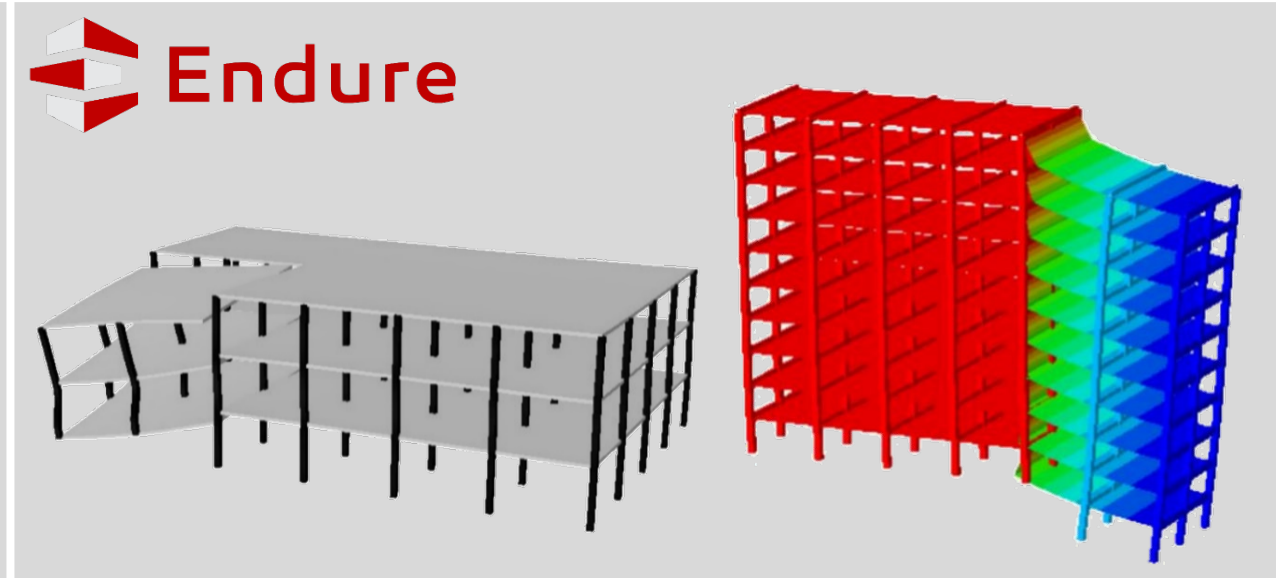

European Research Council  
Established by the European Commission

## Robustness – Progressive collapse

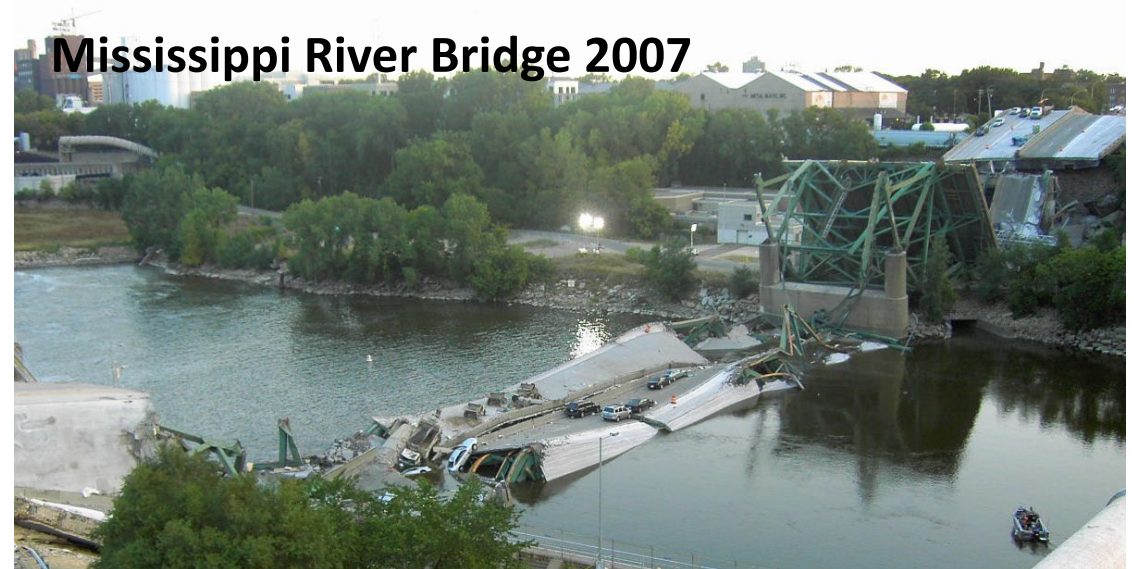

## Endure – ERC Consolidator Grant

To develop a novel fuse-based segmentation design approach to arrest the propagation of failures in building structures

### Analogy

Electrical networks

### Fuse performance

**Continuity** for normal loads or small initial failures (codes)

**Separate** building segments when failure propagation is inevitable

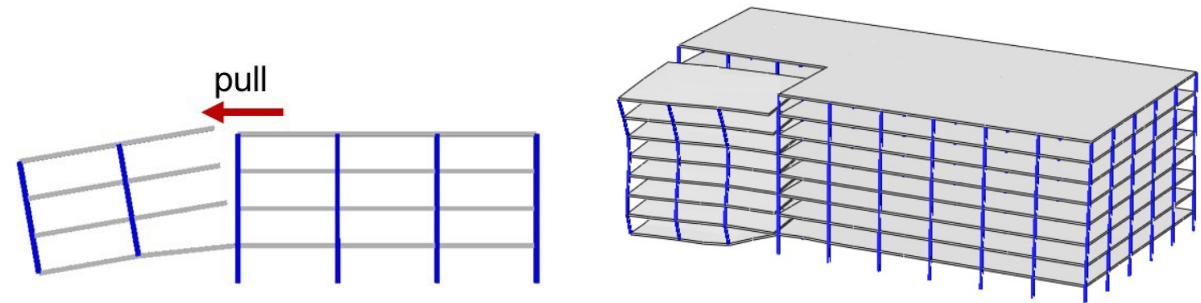
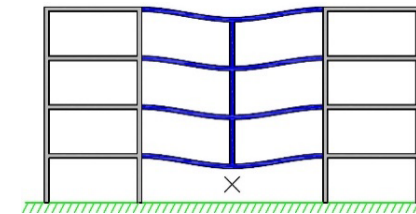

## Endure – ERC Consolidator Grant

